

88 5522 00

Media Hutch

IMPORTANT NOTE

Carefully remove all the parts from the carton and put them individually on a soft cloth to prevent scratches or other damages occuring to the parts.

We have taken great care in the design of this product and request that you carefully and strictly follow our assembly instructions to ensure a completed product as it was designed.

Home
Styles

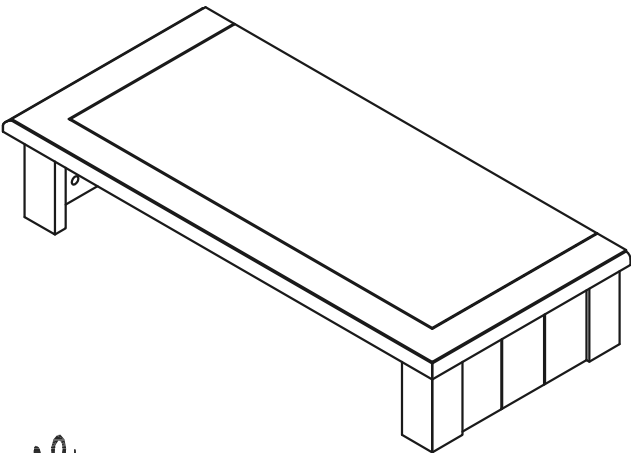

Part List

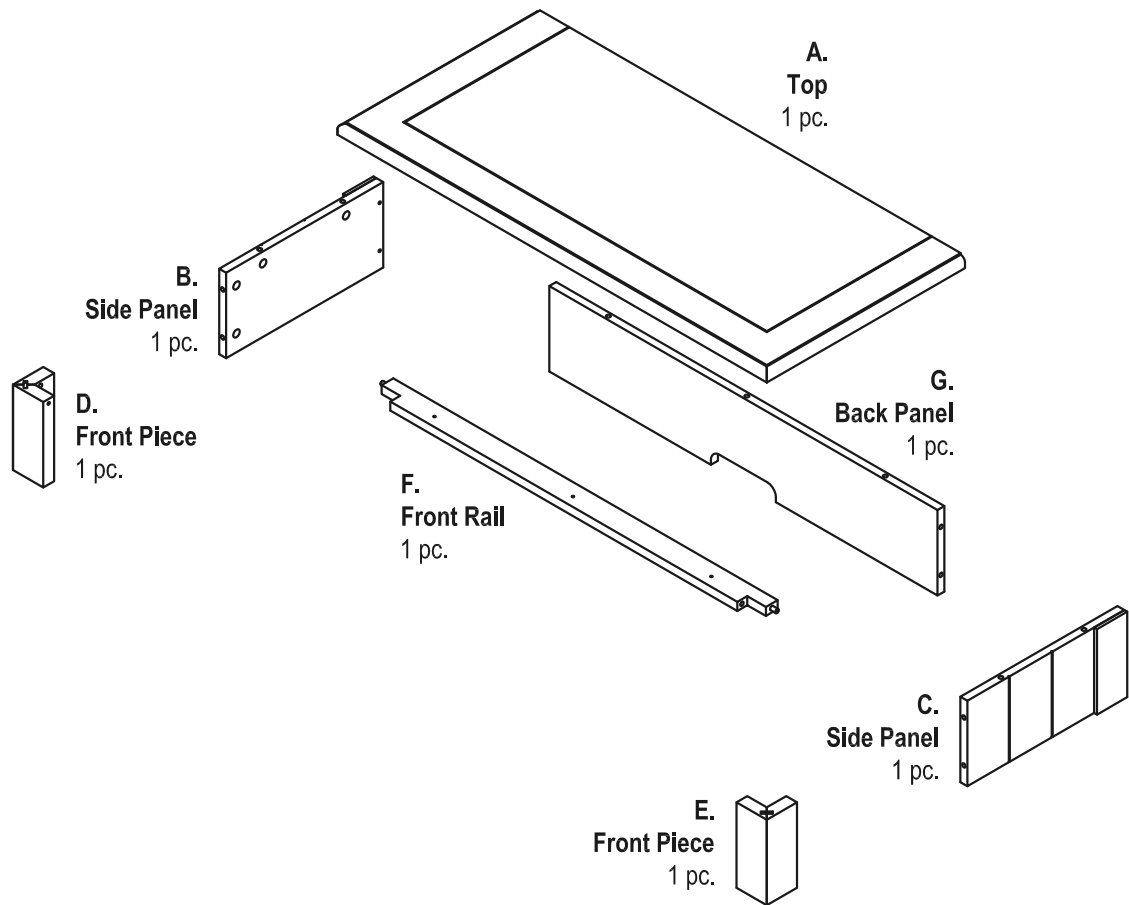

Hardware List



Cam Lock Screw
15 pcs. (+1 extra)



Cam Lock
15 pcs. (+1 extra)



(M3x25)
Screw
3 pcs. (+1 extra)

Tools Required For Assembly : Phillips screwdriver

Home Styles Consumer Assistance: www.homestyles-furniture.com,
servicedesk@homestyles-furniture.com, 888-680-7460, 877-831-0319

Assembly Instructions 2/3

IMPORTANT

- * Do not tighten up all the screws until each part is properly assembled.
- * Use a soft cloth between these parts and the floor.

STEP 1

Insert Cam Lock Screws into the pre-drilled holes of Top (A), Side Panels (B) and (C) and Front Pieces (D) and (E).

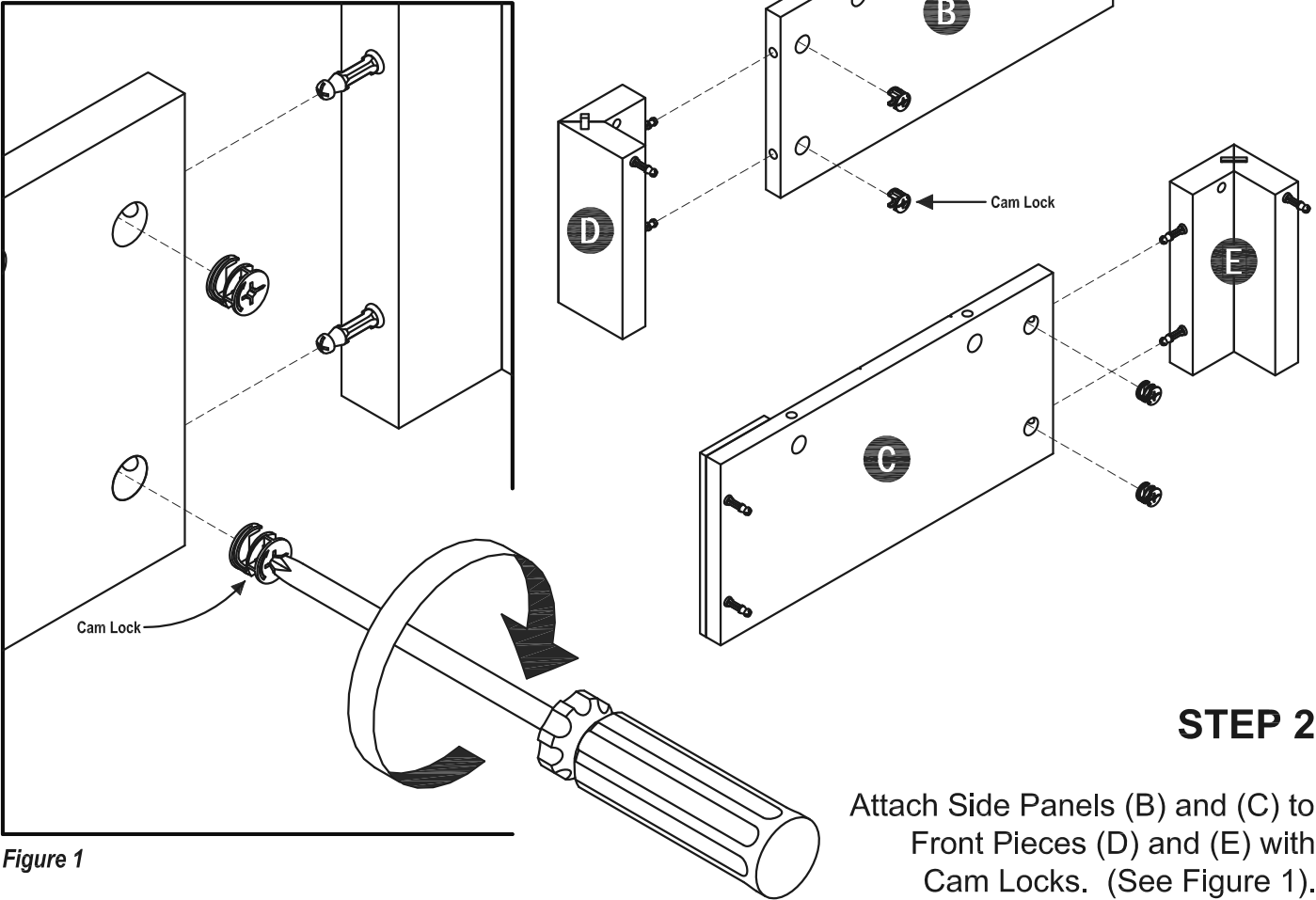
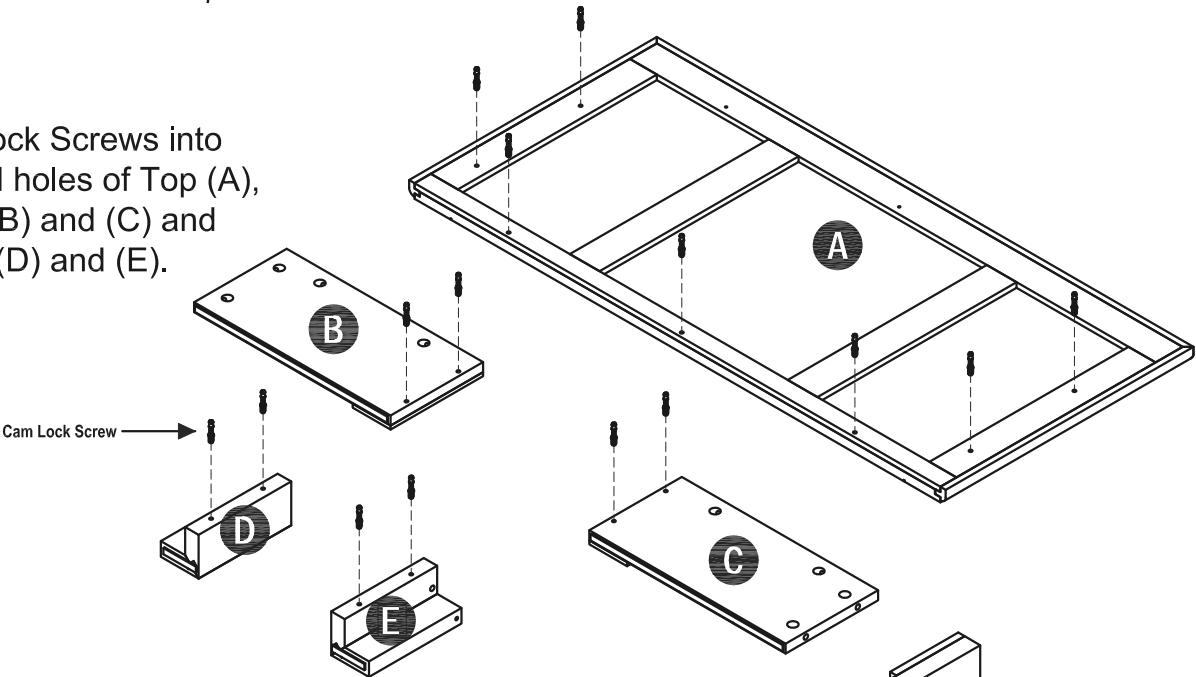

Figure 1

STEP 2

Attach Side Panels (B) and (C) to Front Pieces (D) and (E) with Cam Locks. (See Figure 1).

Assembly Instructions 3/3

STEP 3

Attach unit from Step 2 to Front Rail (F) and Back Panel (G) with Cam Locks.

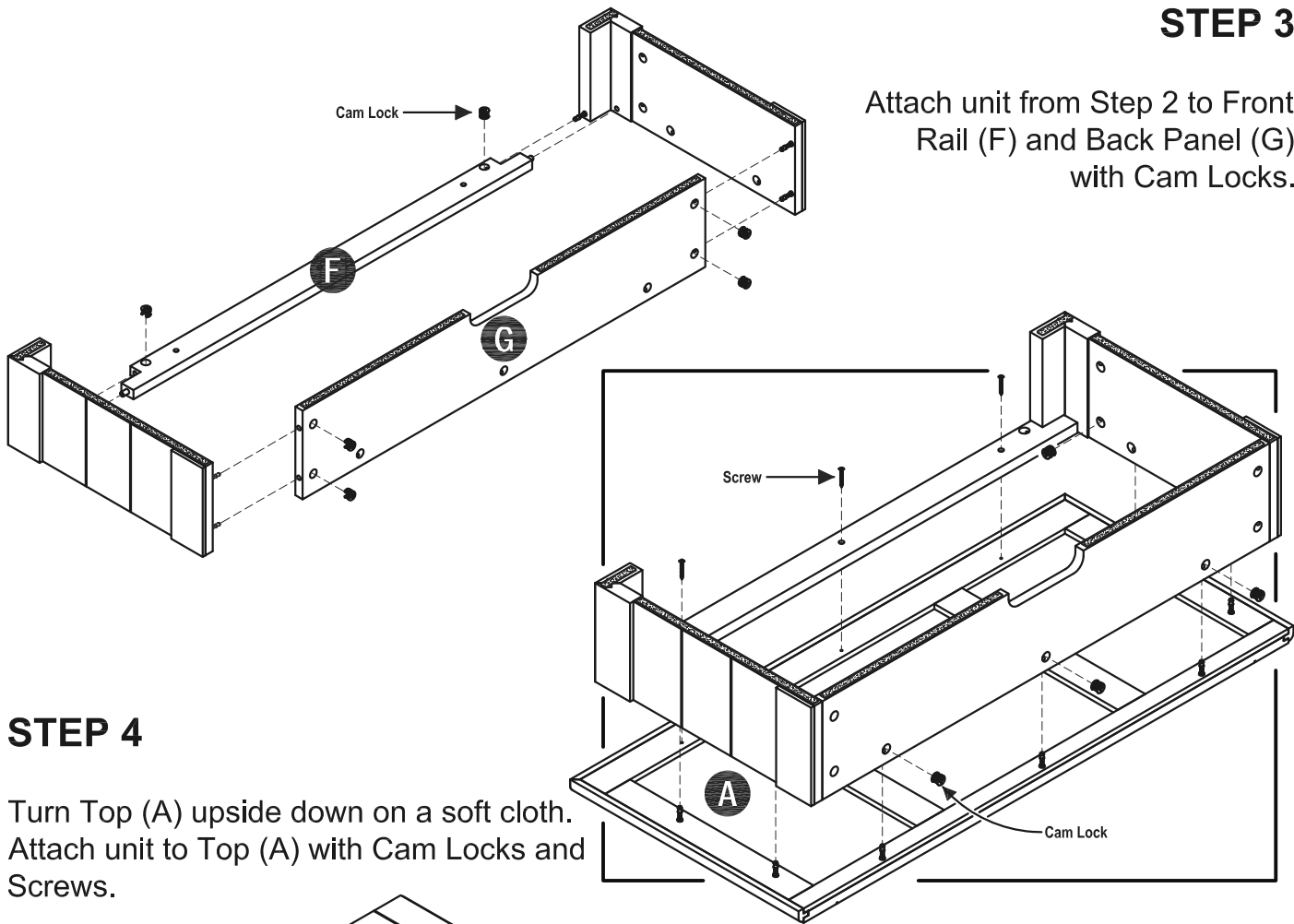

STEP 4

Turn Top (A) upside down on a soft cloth. Attach unit to Top (A) with Cam Locks and Screws.

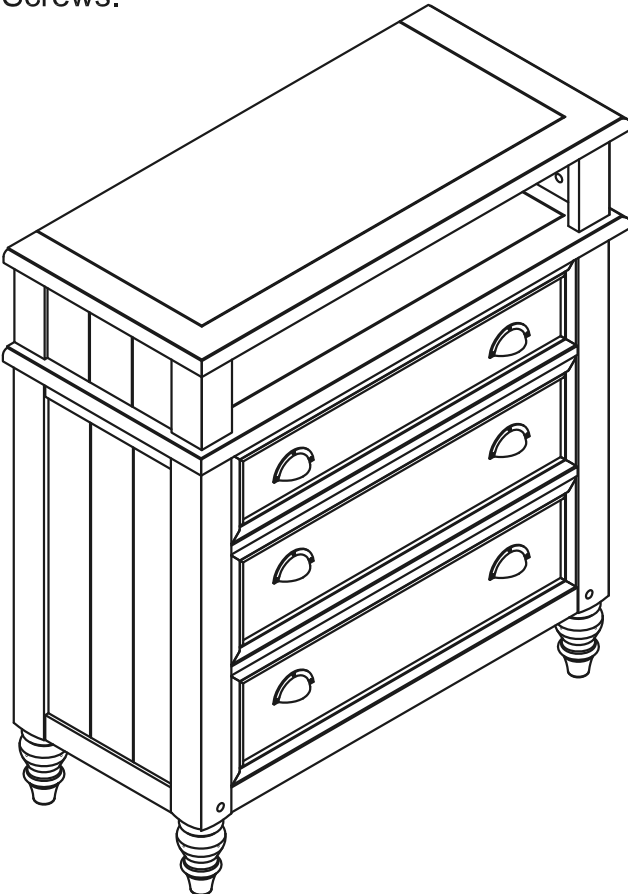

STEP 5

Place the unit on the top of Chest.

VERY IMPORTANT !!

CARE INSTRUCTIONS

NEVER

USE GLASS CLEANERS ON FINISHED FURNITURE. AMMONIA WILL CHEMICALLY ATTACK THE FINISH.

NEVER

ALLOW LIQUIDS OF ANY KIND TO REMAIN ON THE FURNITURE. ABSORPTION CAUSES PART TO WARP AND SPLIT AND FINISHES TO DELAMINATE.

DO NOT
WRITE
DIRECTLY
ON
SURFACE.



**PREVENT
MARKING**

DO NOT
PLACE IN
DIRECT
SUNLIGHT.



**PREVENT
FADING**

DO NOT USE
COMMERCIAL
WAXES AND
POLISHES.



**PREVENT
YELLOWING**

DO NOT
PLACE HOT
OBJECTS
ON SURFACE.



**PREVENT
FINISH DAMAGE**

DO NOT
USE
RUBBER
BASED
PLACE MATS.



**PREVENT
DISCOLORING**

TO CLEAN

USE A SOFT CLOTH MOISTENED IN LUKEWARM SOAP AND WATER, THEN BUFF WITH A DRY CLEAN CLOTH.



Home Styles will provide replacements free of charge for missing or damaged hardware or parts within 30 days of purchase. Digital images of the defective parts may be required. If this product was not purchased from an authorized retail affiliate, Home Styles is under no obligation to provide replacement parts. Parts are not available for fully assembled items nor are parts available for sale. Replacements for missing or damaged hardware or parts may be requested at:

www.homestyles-furniture.com/customer_service

Home Styles Consumer Assistance: www.homestyles-furniture.com,
servicedesk@homestyles-furniture.com, 888-680-7460, 877-831-0319